

FOR SALE OR LEASE



→ OVERVIEW

- Prestigious Sky Harbor Park
- Located minutes from both I-94 and I-294
- Convenient to North Shore
- Immediate possession
- Short term deals welcome
- Institutionally owned and managed

→ PROPERTY STATISTICS

Total Building Size 27,549 square feet	Drive-In Door 1 doors
Available Square Feet 18,799 square feet	Electrical Service 200 amps per unit
Site Size 1.82 acres	Parking Ample
Office Area To suit	Heat Gas
Ceiling Height 16' clear	Lease Rate \$8.50 Gross
Loading Docks 4 exterior docks 2 per unit	Sale Price Subject to Offer

305-311 Era Drive Northbrook, Illinois

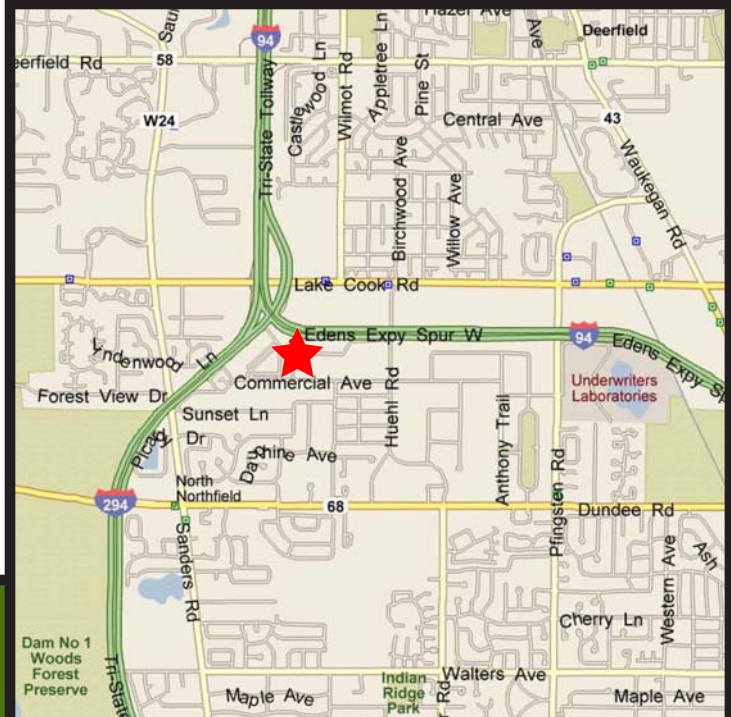

FIRST INDUSTRIAL REALTY TRUST, INC.

311 South Wacker Drive, Suite 4000 | Chicago, Illinois 60606
T: (312) 344-4300 F: (312) 922-6320 www.firstindustrial.com



305-311 Ear Drive
Northbrook, Illinois

FOR SALE OR LEASE

OVERALL BUILDING PLAN
SCALE: 1" = 20'-0"

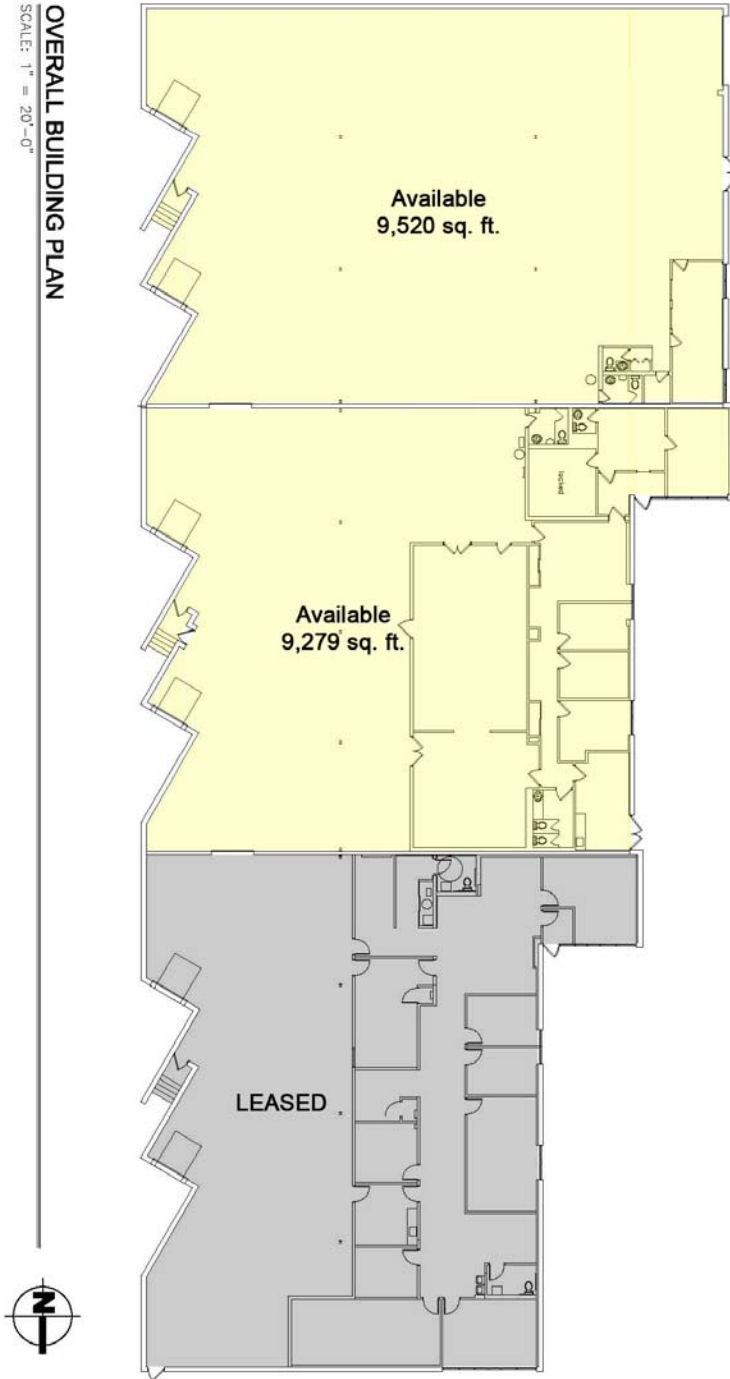

→ CONTACT

For more information contact
our exclusive agents:

Patrick Lederer
(847) 205-4367 office
(847) 533-1019 cell
plederer@kormanlederer.com

Peter Balyeat
(847) 205-4356 office
(773) 495-0133 cell
pbalyeat@kormanlederer.com



All information furnished regarding the property for sale, rental or financing is obtained from sources deemed reliable. No representation is made to the accuracy thereof and is submitted subject to errors, omissions, change of price rental or other conditions, prior sale, lease, or financing, or withdrawal without notice. First Industrial Realty Trust, Inc. represents the Seller in this transaction and as such owes all duties and obligations thereto.

FIRST INDUSTRIAL REALTY TRUST, INC.

311 South Wacker Drive, Suite 4000 | Chicago, Illinois 60606
T: (312) 344-4300 F: (312) 922-6320 www.firstindustrial.com

